

PLACE A POLYGUARD CR INSIDE CORNER BOOT INTO THE CORNER WITH CHEMICAL RESISTANT BACKING FACING THE CONCRETE FORM, OR WALL

POSITION THE BOOT IN THE CORNER WITH THE FACTORY SEAM RUNNING ALONG THE HORIZONTAL PLANE

IMAGE 1

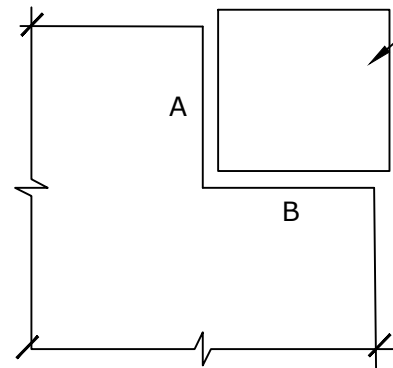

CUT AND REMOVE A SQUARE PIECE OF POLYGUARD CRM MEMBRANE FROM THE END CORNER.

DIMENSION THE STARTING POINT OF EACH CUT FROM THE CORNER, AND ALONG AN EDGE, A DISTANCE EQUAL TO THE HEIGHT OF THE VERTICAL LEG OF THE BOOT. CUT INWARD FROM THE EDGE TO THIS DISTANCE AND DISCARD THE OFF FALL

IMAGE 2

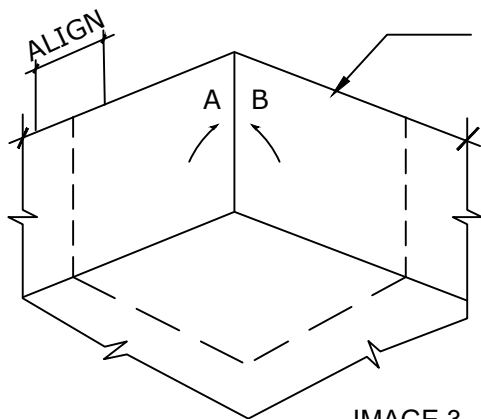

POSITION THE CUT UNDERSEAL CRM INTO THE CORNER AND OVER THE BOOT SO THE A AND B EDGES MEET IN THE VERTICAL LEG OF THE BOOT. FORM-FIT THE PIECE TO THE CONTOURS OF THE CORNER. CREASE THE UNDERSEAL CRM MATERIAL TO ESTABLISH A CONFORMING SHAPE. AFTER CREASING, FOLD THE PIECE BACK, REMOVE THE RELEASE PAPER FROM THE HORIZONTAL LEG OF THE BOOT, THEN OVERLAY AND PRESS THE HORIZONTAL LEG INTO THE BOOT. REPEAT FOR EACH VERTICAL LEG.

IMAGE 3

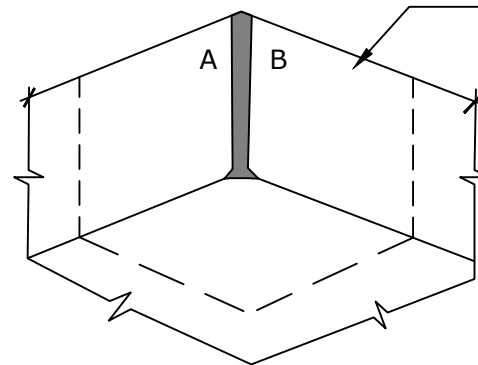

PREPARE THE FABRIC ALONG THE (A) AND (B) EDGES WITH POLYGUARD CR SEALANT APPLIED AT A RATE OF 50 - 75 SF/GAL SEAL THE (A) AND (B) EDGES AND BOTTOM CORNER USING A MINIMUM 90 MIL THICKNESS BY 3/4" WIDE APPLICATION OF POLYGUARD CR LIQUID MEMBRANE TROWELED ONTO EACH LEG AND JOINED AT THE INTERSECTING PLANES.

IMAGE 4

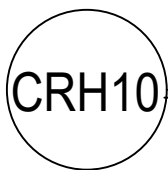

SECTION @ CR INSIDE CORNER BOOT DETAIL

The information provided is based on data and knowledge considered to be true and accurate and is offered for the users' consideration, investigation and verification, but we do not warrant the results to be obtained. Please read all data sheets, statements, recommendations or suggestions in conjunction with our conditions of sale, which apply to all goods supplied by us.	NOT TO SCALE
	EFFECTIVE DATE: 10/01/2022
	SUPERCEDES: 02/04/2022