

POLYGUARD PRM MEMBRANE  
APPLIED TO SUBSTRATE  
PREPARED WITH POLYGUARD 650  
LT LIQUID ADHESIVE OR,  
POLYGUARD CALIFORNIA SEALANT  
AT A RATE OF 250 - 300 SF/GAL OR  
POLYGUARD 650 WB LIQUID  
ADHESIVE AT A RATE OF 350 - 400  
SF/GAL

POLYGUARD TOTALFLOW HIGH  
CAPACITY PERIMETER DRAIN -  
FABRIC FACING BACKFILL AND  
CONNECTS TO THE POLYGUARD  
POLYFLOW 15 / 15P SHEET  
MOLDED DRAIN CONTINUED UP  
THE WALL

POLYGUARD POLYFLOW 15 /15P  
SHEET MOLDED DRAIN FABRIC  
FACING BACKFILL - PRIMARILY FOR  
PROTECTION OF THE MEMBRANE

POLYGUARD DETAIL SEALANT  
PW OR POLYGUARD LM-95  
APPLIED TO TERMINAL EDGE OF  
MEMBRANE

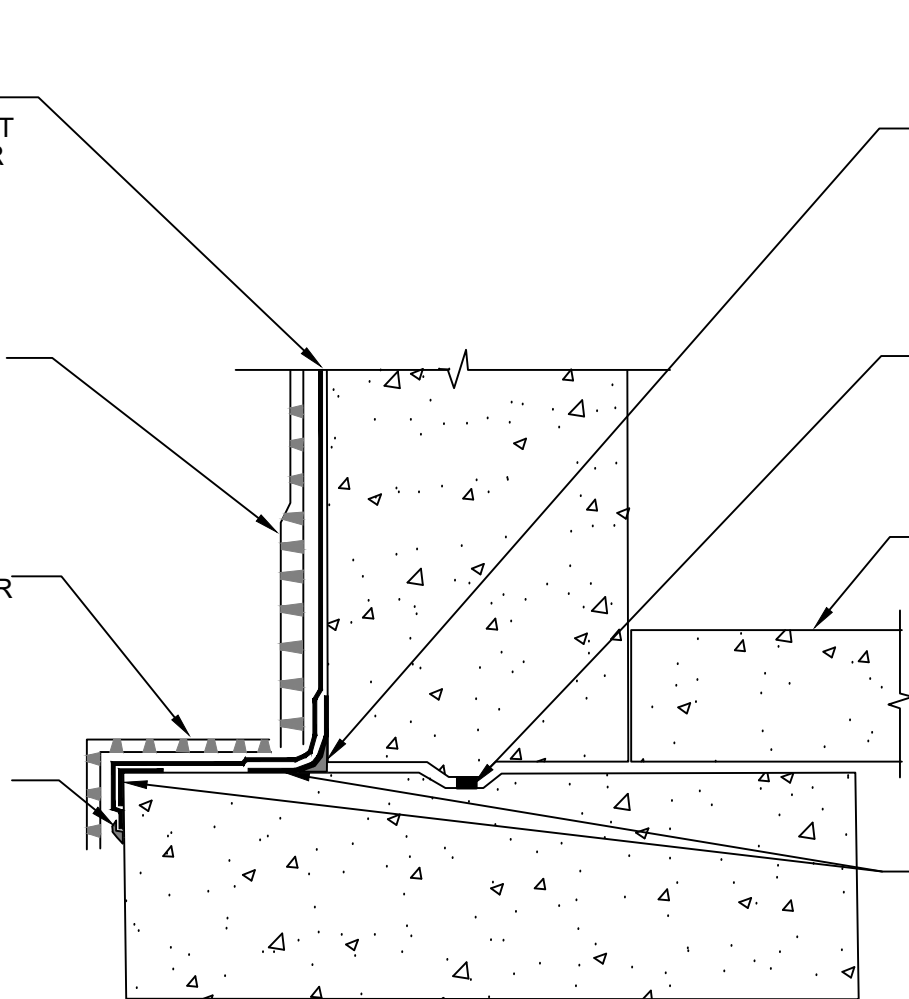

3/4" FILLET OF POLYGUARD DETAIL  
SEALANT PW OR POLYGUARD LM-95  
APPLIED TO INSIDE CORNERS  
VERTICALLY AND HORIZONTALLY  
TO RAW CONCRETE - ALLOW  
POLYGUARD DETAIL SEALANT PW  
TO CURE FOR 2 HOURS PRIOR TO  
SHEET APPLICATION

WATERSTOP PER MANUFACTURES  
RECOMMENDATIONS - BY OTHERS

TOP OF INTERIOR FLOOR HEIGHT  
12" AND UNDER FROM TOP OF  
FOOTER - WATERPROOF AS  
SHOWN - IF FOOTER IS POURED IN  
PLACE FOOTER MEMBRANE MUST  
BE CARRIED OUT 12" AND  
TERMINATED WITH TERMINATION  
BAR AND SEALED WITH  
POLYGUARD DETAIL SEALANT PW  
OR POLYGUARD LM-95

12" STRIP OF POLYGUARD DETAIL  
TAPE OR POLYGUARD 650  
MEMBRANE APPLIED TO INSIDE  
AND OUTSIDE CORNERS - PREPARE  
SUBSTRATE WITH POLYGUARD 650  
LT LIQUID ADHESIVE OR  
POLYGUARD CALIFORNIA SEALANT  
AT A RATE OF 250 - 300 SF/GAL OR  
POLYGUARD 650 WB LIQUID  
ADHESIVE AT A RATE OF 350 - 400  
SF/GAL

**PRM9**

**SECTION @ TOP OF INTERIOR FLOOR 12" AND UNDER FROM TOP OF FOOTER**

©POLYGUARD PRODUCTS, INC.  
MATERIAL SEPARATED FOR CLARITY

Polyguard Products, Inc.  
P.O. Box 755 - Ennis, TX 75120  
Phone: 214-515-5000  
Web Site - www.polyguard.com

**SPECIAL NOTE: IF ADHESIVE IS REQUIRED FOR  
SEAMS OR ENDLAPS DO NOT USE POLYGUARD  
650 WB LIQUID ADHESIVE**

<small>The information provided is based on data and knowledge considered to be true and accurate and is offered for the users' consideration, investigation and verification, but we do not warrant the results to be obtained. Please read all data sheets, statements, recommendations or suggestions in conjunction with our conditions of sale, which apply to all goods supplied by us.</small>	NOT TO SCALE
	EFFECTIVE DATE: 07/15/2024
	SUPERCEDES: 10/01/2022