

POLYGUARD PRM MEMBRANE
APPLIED TO SUBSTRATE
PREPARED WITH POLYGUARD 650
LT LIQUID ADHESIVE OR,
POLYGUARD CALIFORNIA SEALANT
AT A RATE OF 250 - 300 SF/GAL OR
POLYGUARD 650 WB LIQUID
ADHESIVE AT A RATE OF 350 - 400
SF/GAL

POLYGUARD TOTALFLOW HIGH
CAPACITY PERIMETER DRAIN -
FABRIC FACING BACKFILL AND
CONNECTS TO THE POLYGUARD
POLYFLOW 15 / 15P SHEET
MOLDED DRAIN CONTINUED UP
THE WALL

POLYGUARD POLYFLOW 15 / 15P
SHEET MOLDED DRAIN FABRIC
FACING BACKFILL - PRIMARILY FOR
PROTECTION OF THE MEMBRANE

POLYGUARD DETAIL SEALANT
PW OR POLYGUARD LM-95
APPLIED TO TERMINAL EDGE OF
MEMBRANE

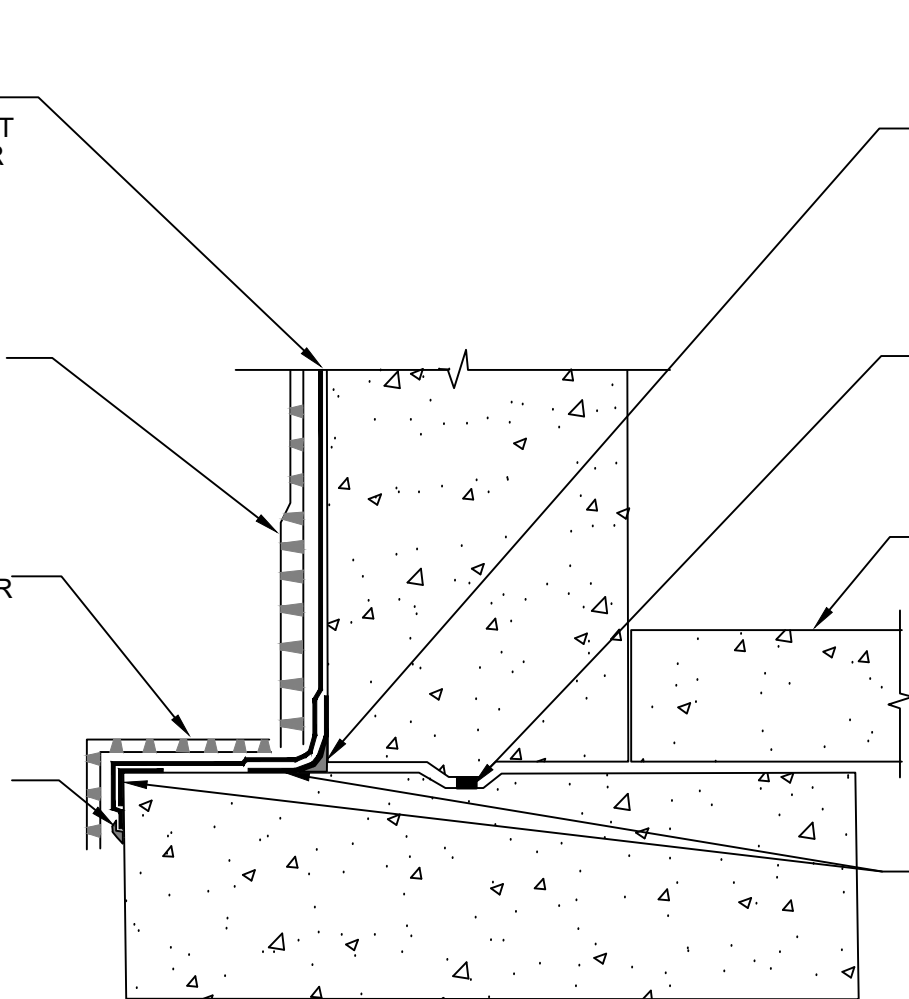

3/4" FILLET OF POLYGUARD DETAIL
SEALANT PW OR POLYGUARD LM-95
APPLIED TO INSIDE CORNERS
VERTICALLY AND HORIZONTALLY
TO RAW CONCRETE - ALLOW
POLYGUARD DETAIL SEALANT PW
TO CURE FOR 2 HOURS PRIOR TO
SHEET APPLICATION

WATERSTOP PER MANUFACTURES
RECOMMENDATIONS - BY OTHERS

TOP OF INTERIOR FLOOR HEIGHT
12" AND UNDER FROM TOP OF
FOOTER - WATERPROOF AS
SHOWN - IF FOOTER IS POURED IN
PLACE FOOTER MEMBRANE MUST
BE CARRIED OUT 12" AND
TERMINATED WITH TERMINATION
BAR AND SEALED WITH
POLYGUARD DETAIL SEALANT PW
OR POLYGUARD LM-95

12" STRIP OF POLYGUARD DETAIL
TAPE OR POLYGUARD 650
MEMBRANE APPLIED TO INSIDE
AND OUTSIDE CORNERS - PREPARE
SUBSTRATE WITH POLYGUARD 650
LT LIQUID ADHESIVE OR
POLYGUARD CALIFORNIA SEALANT
AT A RATE OF 250 - 300 SF/GAL OR
POLYGUARD 650 WB LIQUID
ADHESIVE AT A RATE OF 350 - 400
SF/GAL

PRM9

SECTION @ TOP OF INTERIOR FLOOR 12" AND UNDER FROM TOP OF FOOTER

©POLYGUARD PRODUCTS, INC.
MATERIAL SEPARATED FOR CLARITY

Polyguard Products, Inc.
P.O. Box 755 - Ennis, TX 75120
Phone: 214-515-5000
Web Site - www.polyguard.com

**SPECIAL NOTE: IF ADHESIVE IS REQUIRED FOR
SEAMS OR ENDLAPS DO NOT USE POLYGUARD
650 WB LIQUID ADHESIVE**

<small>The information provided is based on data and knowledge considered to be true and accurate and is offered for the users' consideration, investigation and verification, but we do not warrant the results to be obtained. Please read all data sheets, statements, recommendations or suggestions in conjunction with our conditions of sale, which apply to all goods supplied by us.</small>	NOT TO SCALE
	EFFECTIVE DATE: 10/01/2022
	SUPERCEDES: 05/05/2022