

POLYGUARD UNDERSEAL (US) PREFORMED INSIDE CORNER BOOT (12 X 12 X 12) INTO CORNER WITH POLYETHYLENE SIDE INTERFACING WITH CONCRETE FORM OR WALL

OPTION 1: POLYGUARD UNDERSEAL (US) PREFORMED INSIDE CORNER BOOT

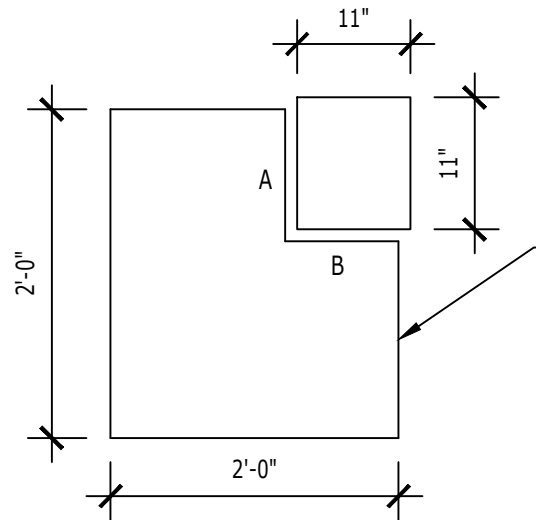

24 X 24 PIECE OF POLYGUARD 650 TRM; CUT AND REMOVE 11" X 11" SQUARE FROM ONE CORNER USING CORNER AS STARTING POINT FOR CUT DIMENSIONS AND CONTINUE ALONG AN EDGE A DISTANCE EQUAL TO HEIGHT OF VERTICAL LEG OF INSIDE CORNER BOOT. CUT INWARD FROM EDGE TO THIS DISTANCE AND DISCARD OFF WALL PIECE.

OPTION 2: FIELD-FORMED POLYGUARD (IMAGE #1) INSIDE CORNER BOOT

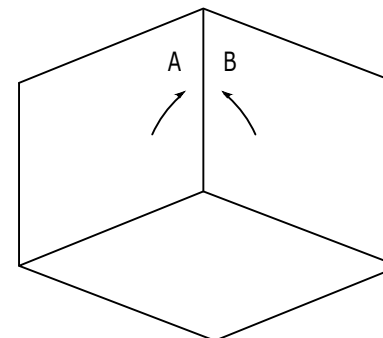

REMOVE 1" OF POLYGUARD 650 TRM FILM SO (A) AND (B) EDGES MEET IN VERTICAL LEG OF BOOT; ROLL VERTICAL SEAM WITH A ROLLER AND UNFOLD TO CREATE INSIDE CORNER BOOT

OPTION 2: FIELD-FORMED POLYGUARD (IMAGE #2) INSIDE CORNER BOOT

UST22 ISOMETRIC @ UNDERSLAB TRM - INSIDE CORNER BOOT (OPTIONS)

The information provided is based on data and knowledge considered to be true and accurate and is offered for the users' consideration, investigation and verification, but we do not warrant the results to be obtained. Please read all data sheets, statements, recommendations or suggestions in conjunction with our conditions of sale, which apply to all goods supplied by us.	NOT TO SCALE
	EFFECTIVE DATE: 12/17/2024
	SUPERCEDES: 12/05/2024