

SECURED PENETRATION MEMBER
CLEAN AND ABRAD 3" OF THE
BASE OF PENETRATION
SIDEWALLS. APPLY POLYGUARD
650 LT LIQUID ADHESIVE OR
POLYGUARD CALIFORNIA
SEALANT AT A RATE OF 250 - 300
SF/GAL OR POLYGUARD 650 WB
LIQUID ADHESIVE AT A RATE OF
350-400 SF/GAL TO SIDEWALLS

3" PIECE OF POLYGUARD
MEMBRANE: 650 OR 650 WRM
WRAPPED AROUND THE PIPE AND
TERMINATION OF TARGET PATCH
AND ONTO CURED POLYGUARD
LM-95 OR POLYGUARD DETAIL
SEALANT PW

TARGET PATCH OF POLYGUARD
MEMBRANE: 650, 650 PRM OR 650
WRM TO CREATE A TIGHT SEAL
AROUND PENETRATION

POLYGUARD DETAIL SEALANT PW
OR POLYGUARD LM-95 APPLY 6"
ON TO RAW CONCRETE AND 3"
ONTO ABRADDED AND PRIMED
PENETRATION

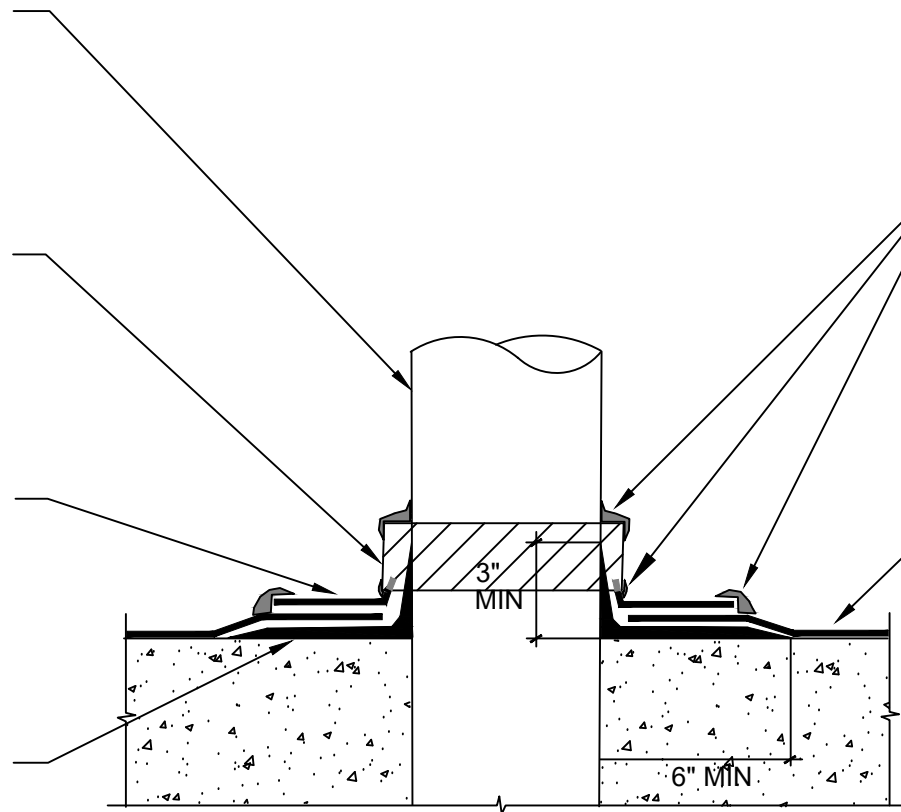

POLYGUARD DETAIL SEALANT
PW OR POLYGUARD LM-95
APPLIED TO TERMINAL EDGES
OF TARGET PATCH

FIELD SHEET OF POLYGUARD
MEMBRANE: 650, 650 PRM OR
650 WRM ROUGH FIT AROUND
PENETRATION APPLIED TO
SUBSTRATE PREPARED WITH
POLYGUARD 650 LT LIQUID
ADHESIVE OR POLYGUARD
CALIFORNIA SEALANT AT A
RATE OF 250 TO 300 SF/GAL OR
POLYGUARD 650 WB LIQUID
ADHESIVE APPLIED AT A RATE
OF 350 - 400 SF/GAL AND OVER
TOP OF POLYGUARD DETAIL
SEALANT PW OR POLYGUARD
LM-95



SECTION@ HORIZONTAL PENETRATION WATERPROOFING

Polyguard Products, Inc.
P.O. Box 755 - Ennis, TX 75120
Phone: 214-515-5000
Web Site - www.polyguard.com

**SPECIAL NOTE: IF ADHESIVE IS REQUIRED FOR
SEAMS OR ENDLAPS DO NOT USE POLYGUARD
650 WB LIQUID ADHESIVE**

©POLYGUARD PRODUCTS, INC.
MATERIAL SEPARATED FOR CLARITY

| | |
|---|-------------------------------|
| <small>The information provided is based on data and knowledge considered to be true and accurate and is offered for the users' consideration, investigation and verification, but we do not warrant the results to be obtained. Please read all data sheets, statements, recommendations or suggestions in conjunction with our conditions of sale, which apply to all goods supplied by us.</small> | NOT TO SCALE |
| | EFFECTIVE DATE: 12/16/2024 |
| | SUPERCEDES: 07/15/2024 |