

DECK DRAIN - BY OTHERS

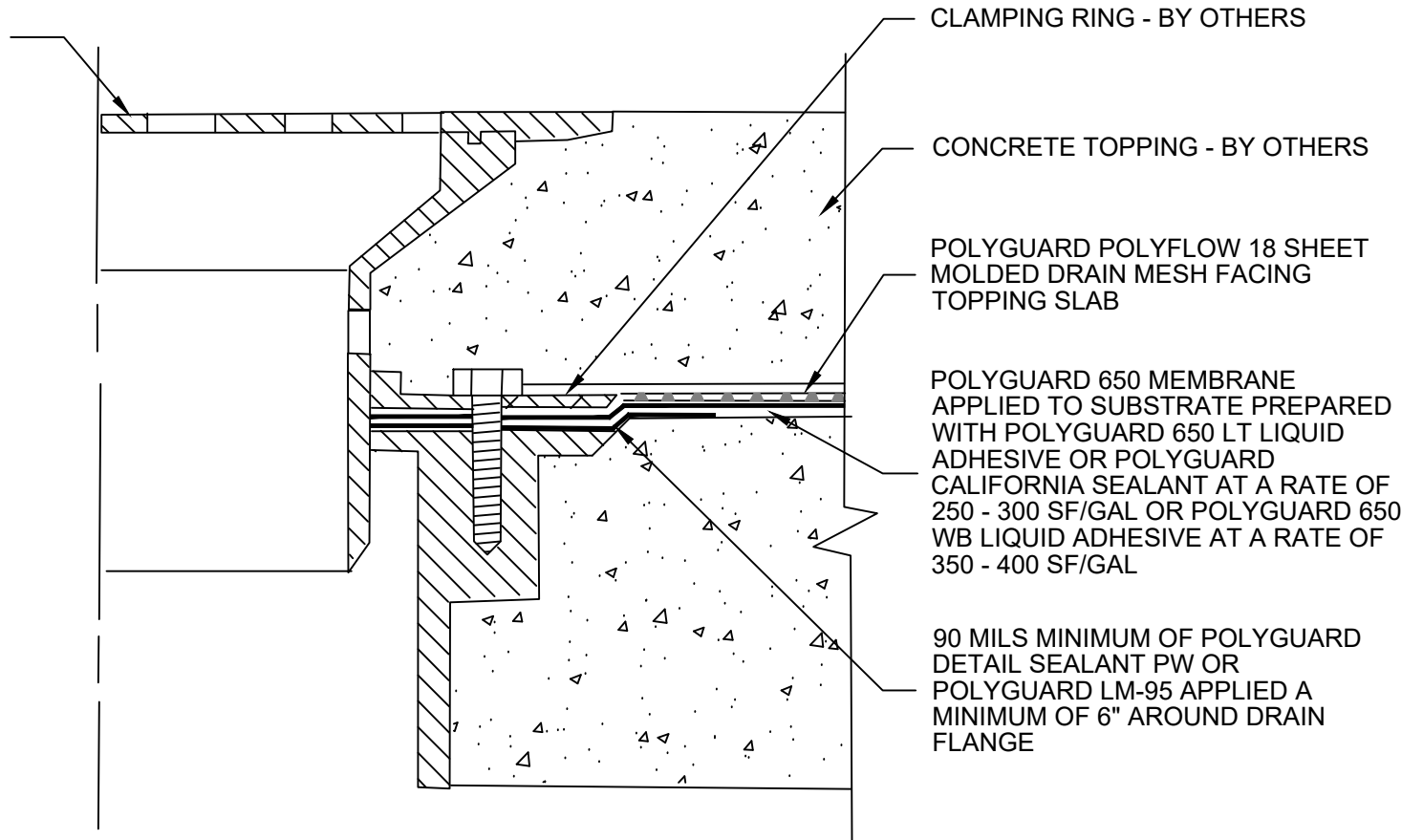

CLAMPING RING - BY OTHERS

CONCRETE TOPPING - BY OTHERS

POLYGUARD POLYFLOW 18 SHEET  
MOLDED DRAIN MESH FACING  
TOPPING SLAB

POLYGUARD 650 MEMBRANE  
APPLIED TO SUBSTRATE PREPARED  
WITH POLYGUARD 650 LT LIQUID  
ADHESIVE OR POLYGUARD  
CALIFORNIA SEALANT AT A RATE OF  
250 - 300 SF/GAL OR POLYGUARD 650  
WB LIQUID ADHESIVE AT A RATE OF  
350 - 400 SF/GAL

90 MILS MINIMUM OF POLYGUARD  
DETAIL SEALANT PW OR  
POLYGUARD LM-95 APPLIED A  
MINIMUM OF 6" AROUND DRAIN  
FLANGE

WP8

SECTION @ DUAL LEVEL DRAIN

Polyguard Products, Inc.  
P.O. Box 755 - Ennis, TX 75120  
Phone: 214-515-5000  
Web Site - www.polyguard.com

**SPECIAL NOTE: IF ADHESIVE IS REQUIRED FOR  
SEAMS OR ENDLAPS DO NOT USE POLYGUARD  
650 WB LIQUID ADHESIVE**

©POLYGUARD PRODUCTS, INC.  
MATERIAL SEPARATED FOR CLARITY

<small>The information provided is based on data and knowledge considered to be true and accurate and is offered for the users' consideration, investigation and verification, but we do not warrant the results to be obtained. Please read all data sheets, statements, recommendations or suggestions in conjunction with our conditions of sale, which apply to all goods supplied by us.</small>	NOT TO SCALE
	EFFECTIVE DATE: 10/01/2022
	SUPERCEDES: 01/17/2022