

POLYGUARD MEMBRANE: 650, 650 PRM OR 650 WRM APPLIED TO SUBSTRATE PREPARED WITH POLYGUARD 650 LT LIQUID ADHESIVE OR, POLYGUARD CALIFORNIA SEALANT AT A RATE OF 250 - 300 SF/GAL OR POLYGUARD 650 WB LIQUID ADHESIVE AT A RATE OF 350 - 400 SF/GAL

POLYGUARD TOTALFLOW HIGH CAPACITY PERIMETER DRAIN - FABRIC FACING BACKFILL AND CONNECTS TO THE POLYGUARD POLYFLOW 15 / 15P SHEET MOLDED DRAIN CONTINUED UP THE WALL

POLYGUARD POLYFLOW 15 / 15P SHEET MOLDED DRAIN FABRIC FACING BACKFILL - PRIMARILY FOR PROTECTION OF THE MEMBRANE

POLYGUARD DETAIL SEALANT PW OR POLYGUARD LM-95 APPLIED TO TERMINAL EDGE OF MEMBRANE

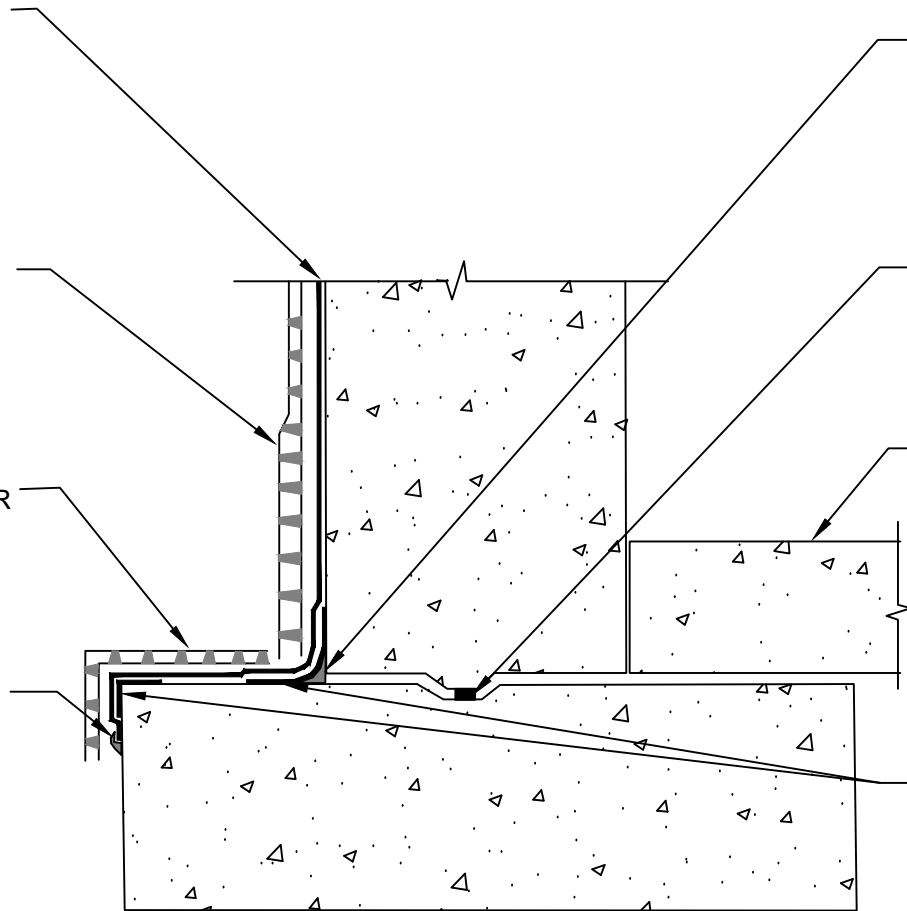

3/4" FILLET OF POLYGUARD DETAIL SEALANT PW OR POLYGUARD LM-95 APPLIED TO INSIDE CORNERS VERTICALLY AND HORIZONTALLY TO RAW CONCRETE - ALLOW POLYGUARD DETAIL SEALANT PW TO CURE FOR 2 HOURS PRIOR TO SHEET APPLICATION

WATERSTOP PER MANUFACTURES RECOMMENDATIONS - BY OTHERS

TOP OF INTERIOR FLOOR HEIGHT 12" AND UNDER FROM TOP OF FOOTER - WATERPROOF AS SHOWN - IF FOOTER IS POURED IN PLACE FOOTER MEMBRANE MUST BE CARRIED OUT 12" AND TERMINATED WITH TERMINATION BAR AND SEALED WITH POLYGUARD DETAIL SEALANT PW OR POLYGUARD LM-95

12" STRIP OF POLYGUARD DETAIL TAPE OR DETAIL TAPE WRM OR 12' PIECE OF POLYGUARD MEMBRANE: 650 OR 650 WRM APPLIED TO INSIDE AND OUTSIDE CORNERS - PREPARE SUBSTRATE WITH POLYGUARD 650 LT LIQUID ADHESIVE OR POLYGUARD CALIFORNIA SEALANT AT A RATE OF 250 - 300 SF/GAL OR POLYGUARD 650 WB LIQUID ADHESIVE AT A RATE OF 350 - 400 SF/GAL

WP9

SECTION @ TOP OF INTERIOR FLOOR IS 12" AND UNDER FROM TOP OF FOOTER

The information provided is based on data and knowledge considered to be true and accurate and is offered for the users' consideration, investigation and verification, but we do not warrant the results to be obtained. Please read all data sheets, statements, recommendations or suggestions in conjunction with our conditions of sale, which apply to all goods supplied by us.	NOT TO SCALE
	EFFECTIVE DATE: 12/16/2024
	SUPERCEDES: 07/15/2024