

POLYGUARD LM-95, DETAIL SEALANT PW, OR TRM SEALANT APPLIED AND TOOLED OVER TERMINATION BAR TOP EDGE AND COVER A MINIMUM 1/8" BEYOND PERIMETER OF EACH FASTENER HEAD

POLYGUARD TRM FLASHING OR 650 TRM STRIP APPLIED AND CENTERED (6" ON EACH CONCRETE FACE) OVER CLEAN, DRY, FROST-FREE, RAW INSIDE AND OUTSIDE CONCRETE CORNERS PREPARED WITH POLYGUARD 650 LT LIQUID ADHESIVE OR CALIFORNIA SEALANT APPLIED AT A RATE OF 250 - 300 SF / GAL, OR OVER 650 WB LIQUID ADHESIVE APPLIED AT A RATE OF 350 - 400 SF / GAL

POLYGUARD 650 TRM APPLIED TO CLEAN, DRY, FROST-FREE, RAW SUBSTRATE PREPARED WITH POLYGUARD 650 LT LIQUID ADHESIVE OR CALIFORNIA SEALANT AT A RATE OF 250 - 300 SF / GAL, OR OVER 650 WB LIQUID ADHESIVE APPLIED AT A RATE OF 350 - 400 SF / GAL - OVERLAPS ARE A MINIMUM 2-1/2" ON SIDE LAPS AND A MINIMUM 6" ON END LAPS

POLYGUARD LM-95, DETAIL SEALANT PW, OR TRM SEALANT APPLIED AND TOOLED TO MINIMUM 90 MILS TO SEAMS 12" FROM POLYGUARD 650 TRM CHANGES IN PLANE, AND ALONG MEMBRANE TERMINAL EDGES AS EDGE SEAL

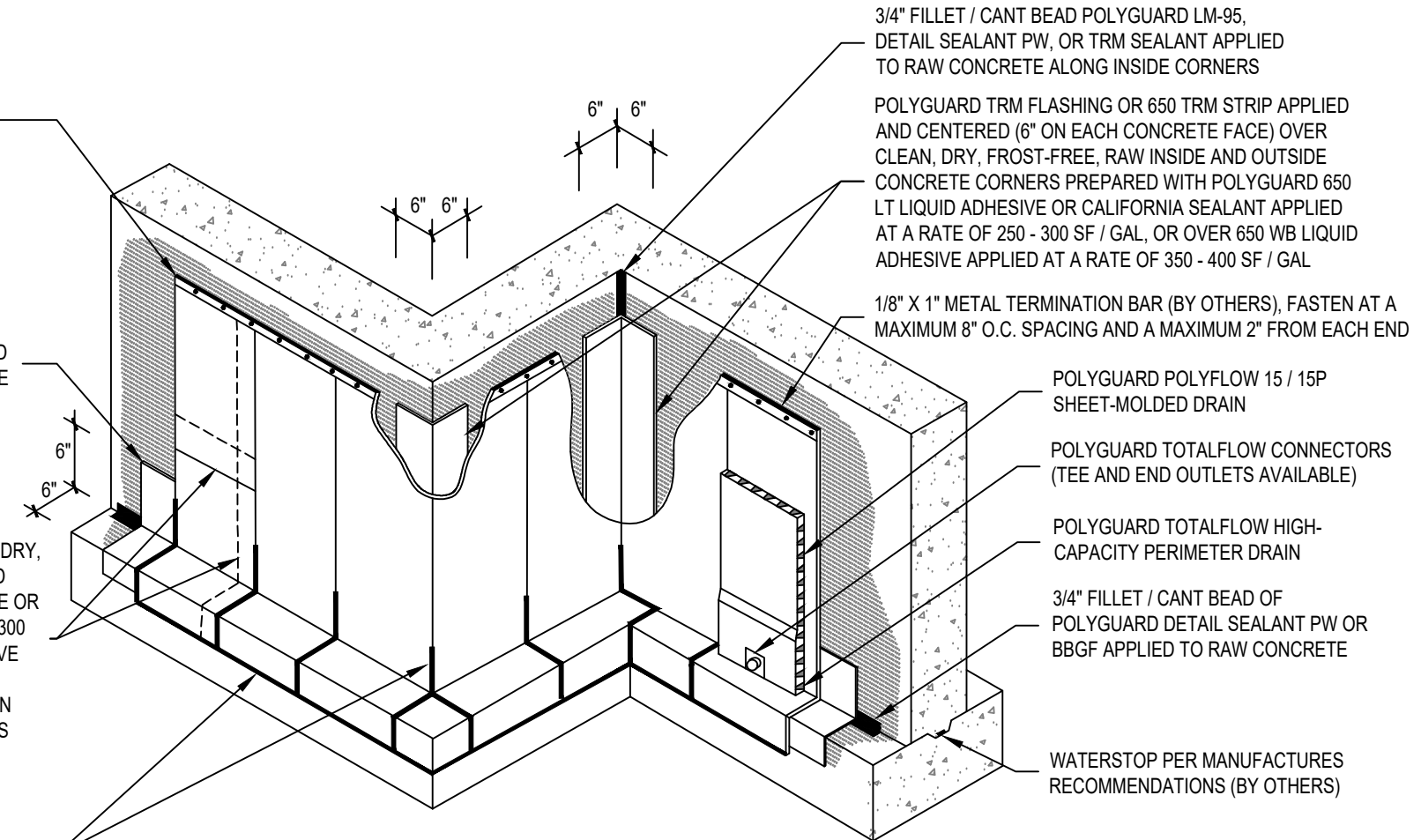

3/4" FILLET / CANT BEAD POLYGUARD LM-95, DETAIL SEALANT PW, OR TRM SEALANT APPLIED TO RAW CONCRETE ALONG INSIDE CORNERS

POLYGUARD TRM FLASHING OR 650 TRM STRIP APPLIED AND CENTERED (6" ON EACH CONCRETE FACE) OVER CLEAN, DRY, FROST-FREE, RAW INSIDE AND OUTSIDE CONCRETE CORNERS PREPARED WITH POLYGUARD 650 LT LIQUID ADHESIVE OR CALIFORNIA SEALANT APPLIED AT A RATE OF 250 - 300 SF / GAL, OR OVER 650 WB LIQUID ADHESIVE APPLIED AT A RATE OF 350 - 400 SF / GAL

1/8" X 1" METAL TERMINATION BAR (BY OTHERS), FASTEN AT A MAXIMUM 8" O.C. SPACING AND A MAXIMUM 2" FROM EACH END

POLYGUARD POLYFLOW 15 / 15P SHEET-MOLDED DRAIN

POLYGUARD TOTALFLOW CONNECTORS (TEE AND END OUTLETS AVAILABLE)

POLYGUARD TOTALFLOW HIGH-CAPACITY PERIMETER DRAIN

3/4" FILLET / CANT BEAD OF POLYGUARD DETAIL SEALANT PW OR BBGF APPLIED TO RAW CONCRETE

WATERSTOP PER MANUFACTURES RECOMMENDATIONS (BY OTHERS)

**WPT3a**

**ISOMETRIC @ 650 TRM - CONCRETE / CMU FOUNDATION WALL (OVERVIEW)**

Polyguard Products, Inc.  
P.O. Box 755 - Ennis, TX 75120  
Phone: 214-515-5000  
Web Site - www.polyguard.com

**GENERAL NOTE: IF ADHESIVE IS REQUIRED FOR SEAMS OR END LAPS, DO NOT USE POLYGUARD 650 WB LIQUID ADHESIVE.**

© POLYGUARD PRODUCTS, INC.

The information provided is based on data and knowledge considered to be true and accurate and is offered for the users' consideration, investigation and verification, but we do not warrant the results to be obtained. Please read all data sheets, statements, recommendations or suggestions in conjunction with our conditions of sale, which apply to all goods supplied by us.	NOT TO SCALE
	EFFECTIVE DATE: 12/17/2024
	SUPERCEDES: 12/10/2024