

- 7) EXTERIOR CONCRETE MOW STRIP
- 6) ALTERNATE TO STEP (5): INSTALL STEEL REBAR DOWEL AT TIME OF REINFORCING STEEL INSTALLATION. EMBED DOWEL 1'-0" INTO SOIL, AND EMBED INTO SLAB TO DEPTH NEAR TOP OF CONCRETE POUR. SPACE DOWELS EVERY 3 FEET ALONG MOW STRIP.
- 5) STEEL REBAR DOWEL TYING NEW MOW STRIP TO EXISTING SLAB OR FOUNDATION WALL, EXTENDING 2" INTO EXISTING CONCRETE AND 4" INTO MOW STRIP, INSTALLED 2" FROM TOP OF MOW STRIP AND SPACED EVERY 3 FEET ALONG MOW STRIP
- 4) POLYGUARD TERM PARTICLE TERMITE BARRIER INSTALLED AGAINST CLEAN EXISTING CONCRETE AND ON TOP OF ROOT BARRIER JUST PRIOR TO CONCRETE MOW STRIP POUR
- 3) POLYGUARD ROOT BARRIER COVERING SOIL SURFACE BUT NOT CONCRETE SURFACE
- 2) DIG WEDGE-SHAPED TRENCH 6" DEEP AND 5" WIDE
- 1) EXISTING CONCRETE SLAB OR FOUNDATION

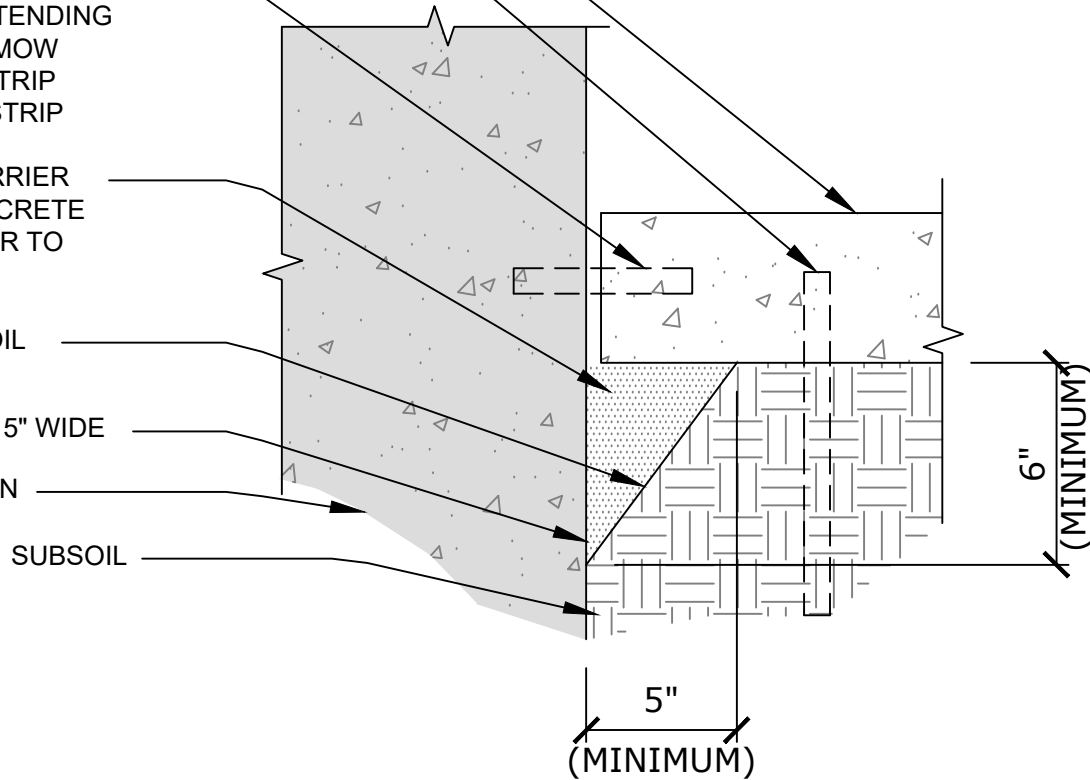

TPC5

SECTION @ TERM[®] PARTICLE BARRIER UNDER MOW STRIP ADJACENT TO EXISTING CONCRETE STRUCTURE
 (BASED ON US ARMY CORPS OF ENGINEERS PACIFIC ISLAND INSTALLATION TERMITE BARRIER DETAIL)

©POLYGUARD PRODUCTS, INC.

P.O. Box 755 - Ennis, TX 75120
 Phone: 214-515-5000 Fax: 972-875-9425
 Web Site - www.polyguardbarriers.com



polyguard
 TERM BARRIER

The information provided is based on data and knowledge considered to be true and accurate and is offered for the users' consideration, investigation, and verification; but we do not warrant the results to be achieved. Please read all data sheets, statements, suggestions, or recommendations in conjunction with our conditions of sale, which apply to all goods supplied by us.

DRAWING SCALE:	NOT TO SCALE
EFFECTIVE DATE:	05/25/2021
SUPERCEDES:	05/12/2021